

WAFER-BT

3.5" Single Board Computer

Quick Installation Guide

Version 2.20

May, 2025

Features

- Intel® Celeron® Processor J1900 / N2807 / N2930 on-board SoC
- One 204-pin 1066/1333 MHz DDR3L SO-DIMM slot supports up to 8 GB (for J1900 & N2930) or 4 GB (for N2807)
- Support VGA and LVDS dual display outputs, and iDP interface
- Support two PCIe GbE ports via Intel® I210 controllers
- Two SATA 3Gb/s, one USB 3.0, five USB 2.0, one RS-422/485, three RS-232 connectors
- One full-size PCIe Mini card slot with mSATA support, and one half-size PCIe mini card slot

Packing List

- 1 x WAFER-BT single board computer
- 1 x Power cable
- 2 x RS-232 cable
- 2 x SATA with power cable kit
- 1 x Audio cable
- 1 x QIG (Quick Installation Guide)

Jumpers & Connectors

J_ATX_AT1: AT/ATX power mode setting jumper	
Status	Description
Short A – B	ATX power mode (default)
Short B – C	AT power mode

J_CMOS1: Clear CMOS button	
Status	Description
NC	Keep CMOS setup (normal operation)
Press	Clear CMOS setup

J_FLASH1: Flash descriptor security override jumper	
Status	Description
Short 1-2	No override mode (Default)
Short 2-3	Override mode

CN4: Front panel connector			
Pin	Description	Pin	Description
1	+5V	4	PWR_LED-
2	GND	5	HDD_LED+
3	PWR_LED+	6	HDD_LED-

Get more information:



WAFER-BT



IEI Resource Download Center

Dimensions (Unit: mm)

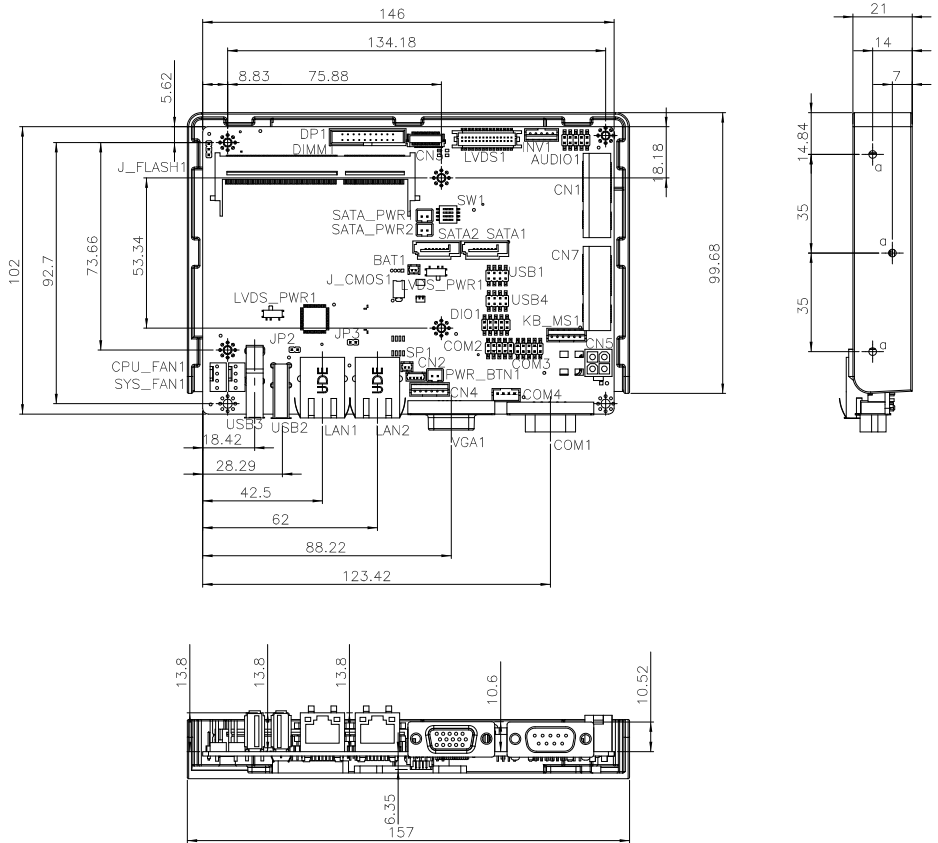

Safety Instructions



Warning! Read the QIG before connecting the system to the power source.

Warning! To prevent the system from overheating, do not operate it in an area that exceeds the maximum operating temperature described in the user manual.

Warning! Ultimate disposal of this product should be handled according to all national laws and regulations.

Support



IEI Support URL

http://new.ieiworld.com/tw/online_support_form



Compliance



This equipment has been tested and found to comply with specifications for CE marking. If the user modifies and/or installs other devices in the equipment, the CE conformity declaration may no longer apply.



This equipment complies with Part 15 of the FCC Rules. Operation is subject to the following two conditions:

-  This device may not cause harmful interference, and
-  This device must accept any interference received, including interference that may cause undesired operation.

This equipment has been tested and found to comply with the limits for a Class A digital device, pursuant to part 15 of the FCC Rules. These limits are designed to provide reasonable protection against harmful interference when the equipment is operated in a commercial environment. This equipment generates, uses, and can radiate radio frequency energy and, if not installed and used in accordance with the instruction manual, may cause harmful interference to radio communications. Operation of this equipment in a residential area is likely to cause harmful interference in which case the user will be required to correct the interference at his own expense.



According to the requirement of the WEEE legislation the following user information is provided to customers for all branded IEI Electronics products subject to the WEEE directive.

This symbol on the product or on its packaging indicates that this product must not be disposed of with your other household waste. Instead, it is your responsibility to dispose of your waste equipment by handing it over to a designated collection point for the recycling of waste electrical and electronic equipment. The separate collection and recycling of your waste equipment at the time of disposal will help to conserve natural resources and ensure that it is recycled in a manner that protects human health and the environment. For more information about where you can drop o- your waste equipment for recycling, please contact your local city office, your household waste disposal service or the shop where you purchased the product.

Headquarters

IEI Integration Corp.

No. 29, ZhongXing Rd., Xizhi Dist.,
New Taipei City 221, Taiwan
TEL: +886-2-8691-6798/+886-2-2690-2098
FAX: +886-2-6616-0028
sales@ieiworld.com
www.ieiworld.com

USA

IEI Technology USA Corp.

138 University Parkway, Pomona,
CA 91768, USA
Tel: +1-909-595-2819
Fax: +1-909-595-2816
sales@usa.ieiworld.com
usa.ieiworld.com

China

IEI Integration (Shanghai) Corp.

No. 515, Shen Fu Rd., Xin Zhuang Industrial Develop Zone,
Shanghai, 201108, China
Tel: +86-21-3116-7799
Fax: +86-21-3462-7797
sales@ieiworld.com.cn
www.ieiworld.com.cn